

COTE OPERATEUR
OPERATORS SIDE
BEDIENUNGSEITE

A - A
PLATEAU MOBILE
MOVING PLATEN
BEWGL. WAP

COTE OPPOSE A L'OPERATEUR
REAR SIDE
BEDIENUNGSGEGENSEITE

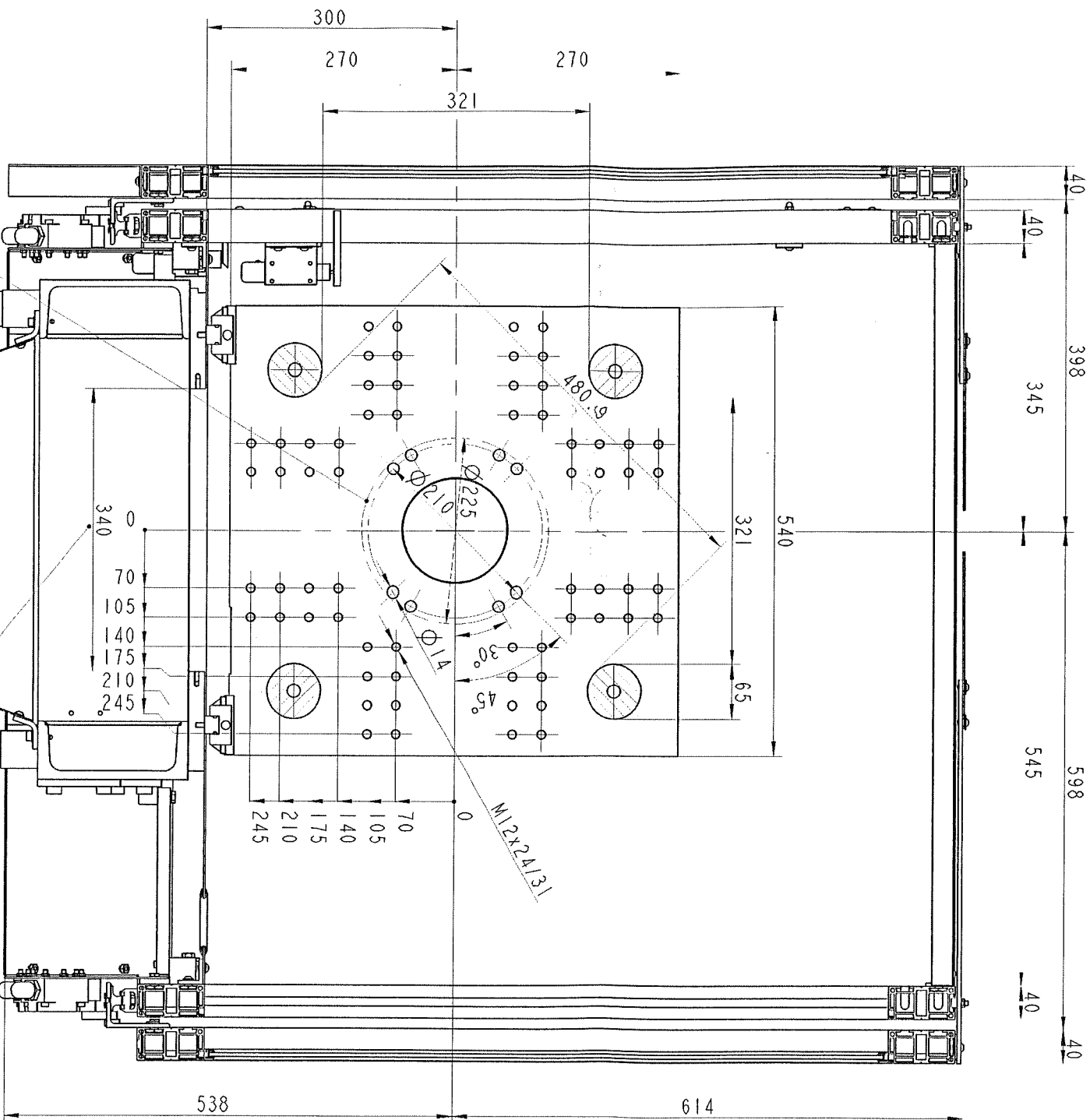

DIAMETER MIN. DU MOULE
MIN. DIAMETER OF MOULD
MIN. WERKZEUG- ϕ

POIDS TOTAL MAX. DE MOULE
MAX. TOTAL MOULD WEIGHT
WERKZEUGGEWICHT GES. 400KG

OUVERTURE D'EJECTION
DROP-OUT OPENING
AUSFALLOFFNUNG

B - B
PLATEAU FIXE
FIXED PLATEN
FESTE WAP

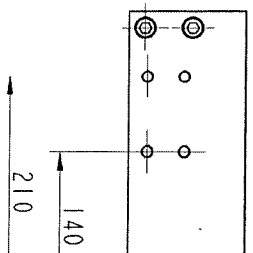
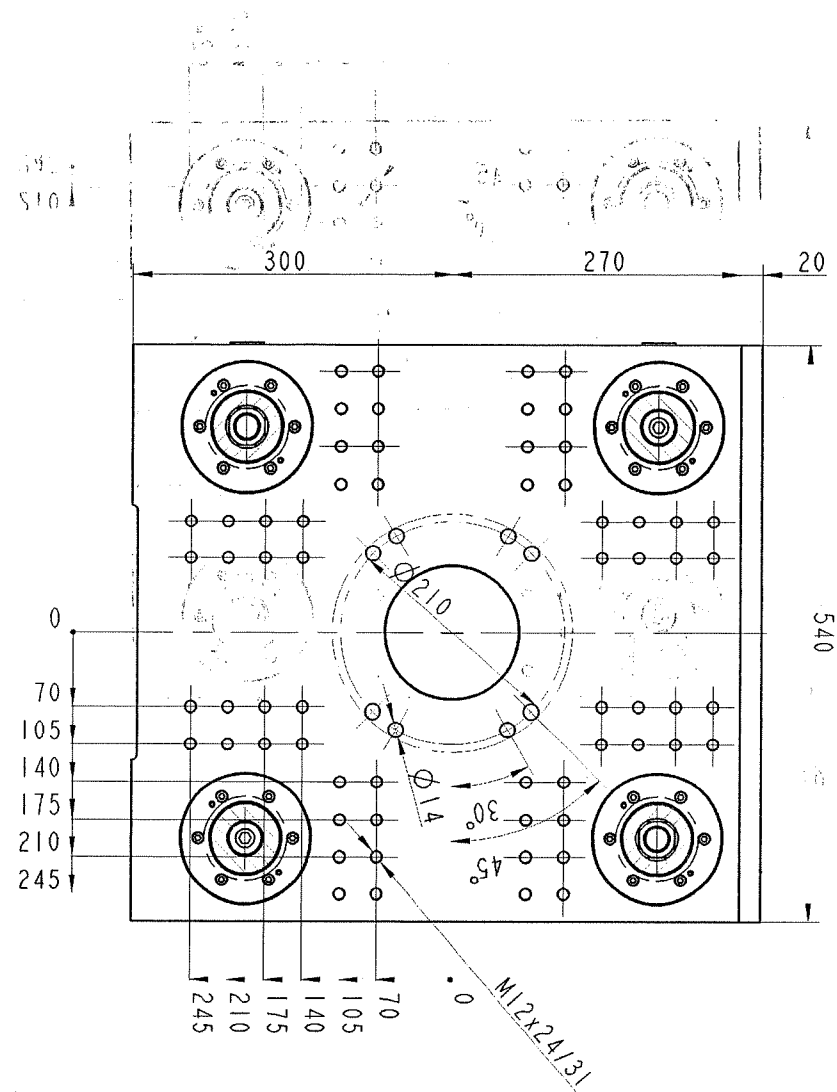

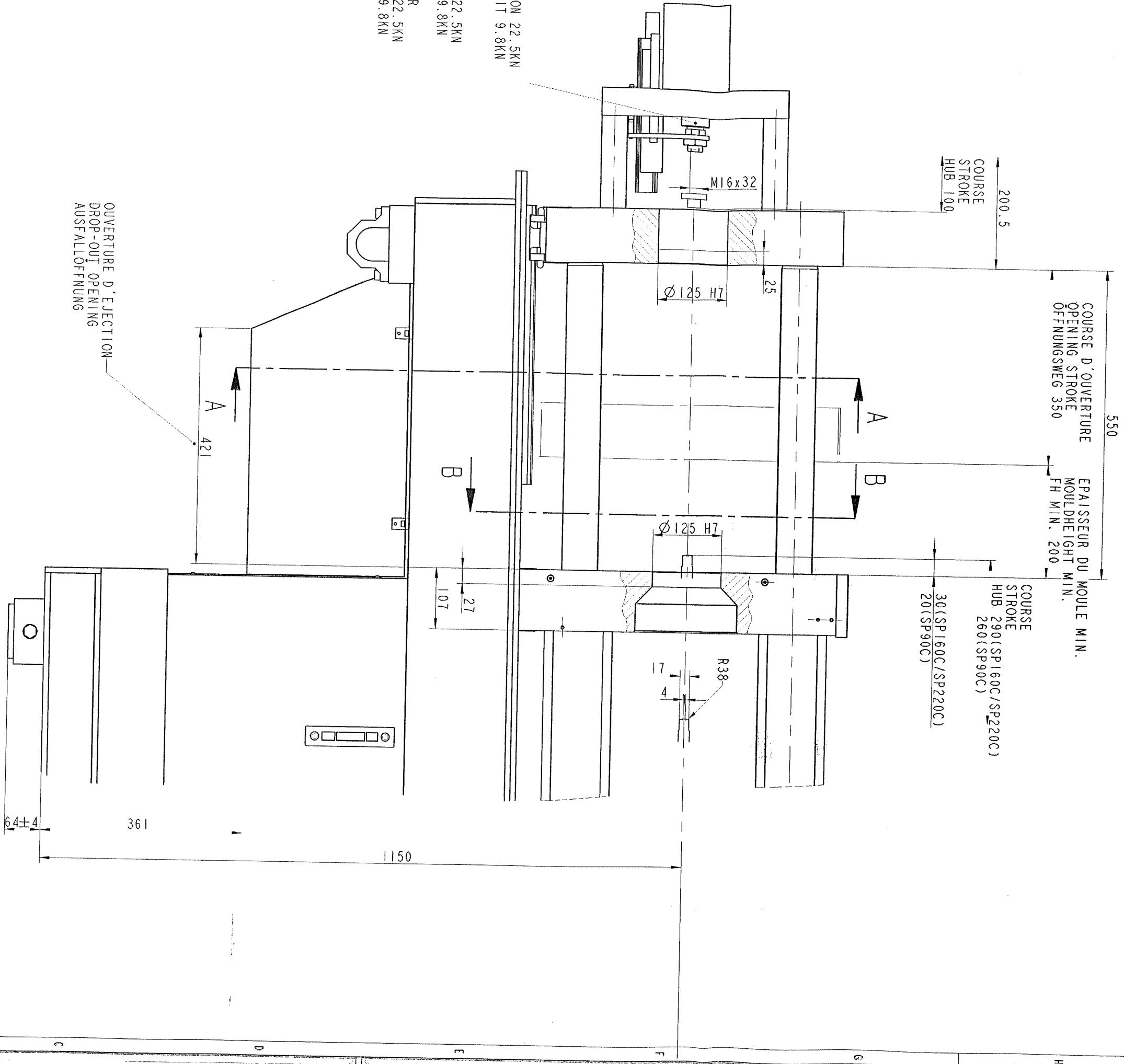

TION 22.5KN
 RAIT 9.8KN
 E 22.5KN
 E 9.8KN
 FER
 T 22.5KN
 T 9.8KN

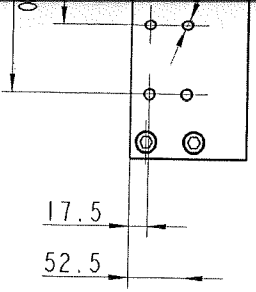

Verwendbar für		Mögliche fertigungsgoßen stärke		DIN ISO 1302		Maßstab 1:5		Fert. Gew. ... kg	
KM40/50C		MM-Norm M0100		1302		1:5		...	
SP90/160/220C		2001		AA/DA		WKZG. ANSCHLUSSMASSE		...	
		Bearb. 07.02.		KC		PLATEN LAYOUT		...	
		Gspr. 07.02.				INFO. PR. FIXATION MOULE		...	
		Norm.						...	
		Abt. KTI111						...	
								...	
								...	
								...	
								...	

Mitro ZUST	Kommitvor Andfr.	Datum	Name	U-spr.	6484591.2	KraussMaffei	Soch-Nr.	19B9404Y	Mod./Ges-Nr.	8190722	Ans. I	Breit-Nr.	1
WKZG. ANSCHLUSSMASSE													
PLATEN LAYOUT													
INFO. PR. FIXATION MOULE													
Ers. f.:													